

# VentA Hood® ISLAND RANGE HOOD SPECIFICATIONS

**CILH9** Equipped with halogen lighting. These models not available with heat lamps. Shown with optional duct cover (sold separately). Optional duct covers available in standard and custom sizes. Galley rail included.

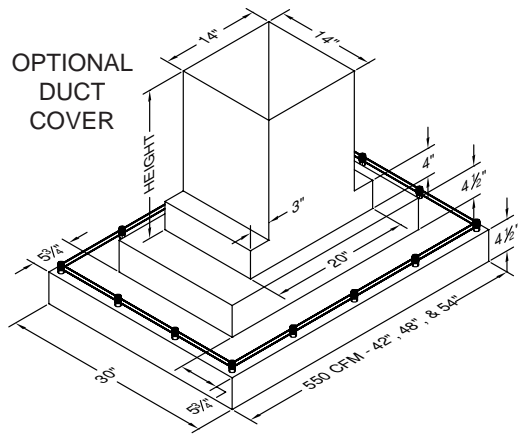

**CILH9 (550 CFM)**

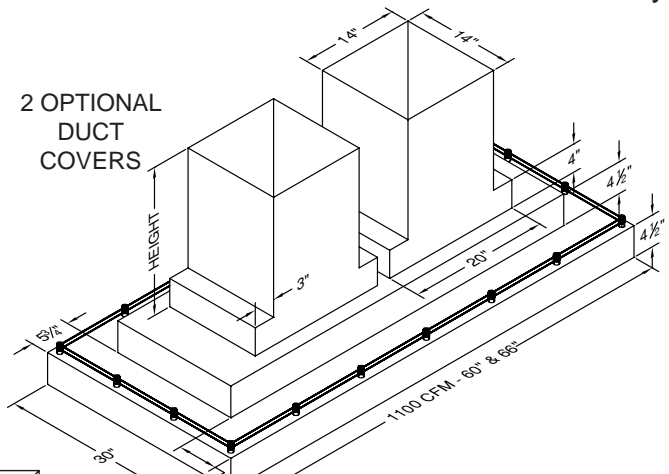

**CILH9 (1100 CFM)**

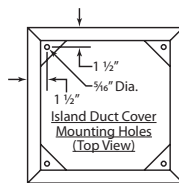

**Recommended Mounting Height\***

## Connection Diagram (42"- 54" Widths)

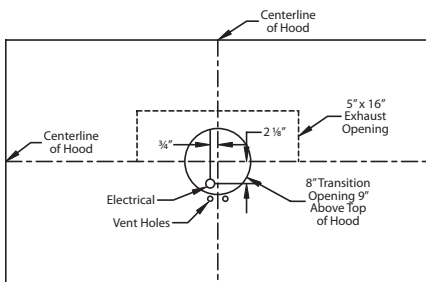

**550 CFM T200 Dual Blower (Top View)**

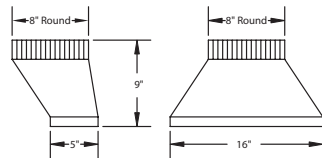

**VP565 Transition (Included)**

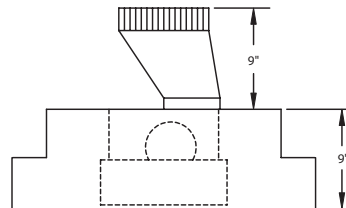

**Transition Installed (Side View)**

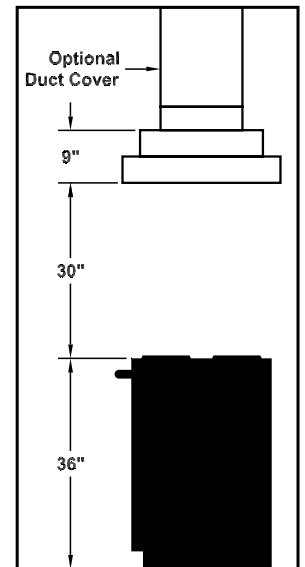

\*Exceeding recommended mounting height may compromise performance.

## Connection Diagram (60"- 66" Widths)

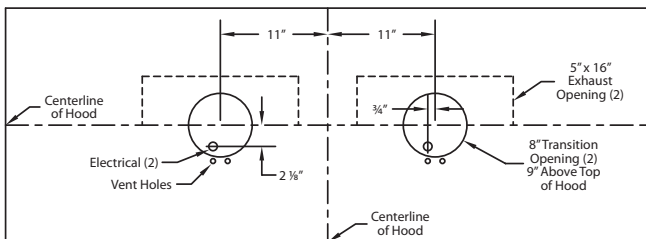

**1100 CFM T2+200 Dual Blower (Top View)**

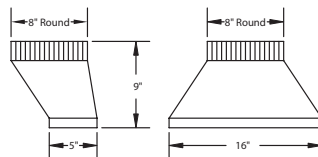

**VP565 Transition (2 Included)**

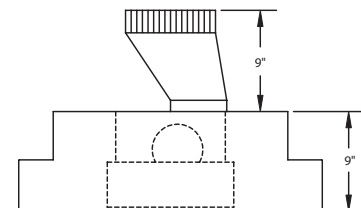

**Transition Installed (Side View)**

## Electrical/Mechanical Specifications For Blower Units

Model	Volts	Amps*	Hz	RPM	CFM SP@0.0"	Equivalent CFM*	CFM SP@0.1"	CFM SP@0.2"	CFM SP@0.3"	Minimum Round Duct Size	Sones#
T200 Island Dual	115	2.9	60	1550	550	900	507	471	431	8" (50 in. <sup>2</sup> )	6.0

\* Add 0.5 amp for each halogen light. Hood is available with halogen lights (one in each corner).

# Because the Magic Lung® blower uses centrifugal filtration rather than conventional baffle or mesh filters, the Magic Lung® blower can handle cooking equipment with higher cubic feet per minute (CFM) requirements and can deliver equivalent CFM much more efficiently than other filtration systems. When comparing the Magic Lung® with other blower units made by other manufacturers, use the "Equivalent CFM".

# Ratings in accordance with the Standard Test Code by the Energy Systems Laboratory of the Texas Engineering Experiment Station.

SPECIFICATIONS SUBJECT TO CHANGE WITHOUT NOTICE Rev. 0210A

