

VentA Hood® WALL MOUNT LINER INSERT SPECIFICATIONS

BH340PSLB/B446PSLB/BH446PSLB LINER "H" in model number designates halogen lighting. BH340PSLB is available with halogen lights only. This model not available with heat lamps.

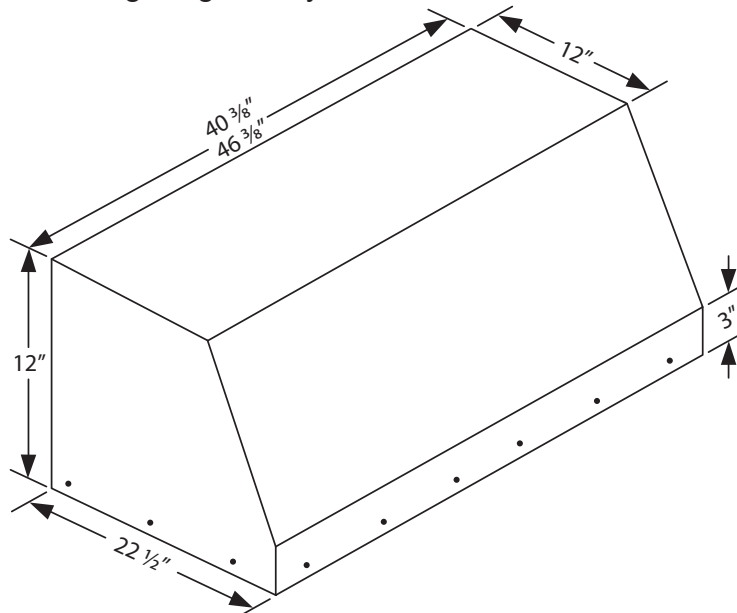

BH340PSLB/B446PSLB/BH446PSLB

Connection Diagram (BH340PSLB)

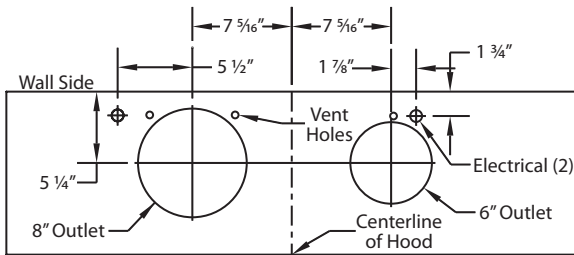

900 CFM B200 Dual & B100 Single Blowers (Top View)

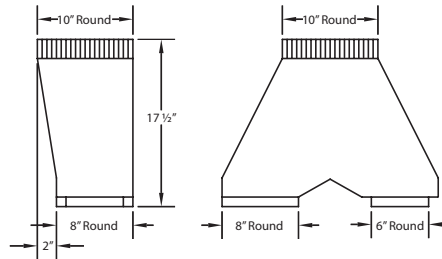

VP562 Transition (Optional) For B300 (B200 Dual & B100 Single Blowers)

Connection Diagram (B446PSLB/BH446PSLB)

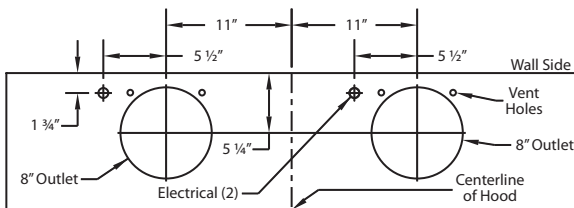

1200 CFM Double B200 Dual Blowers (Top View)

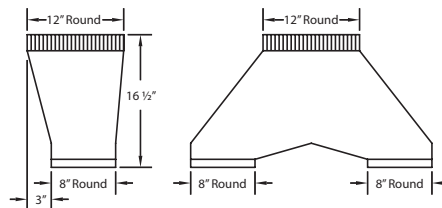

VP563 Transition (Optional) For B400 (Double B200 Dual Blowers)

Recommended Mounting Height*

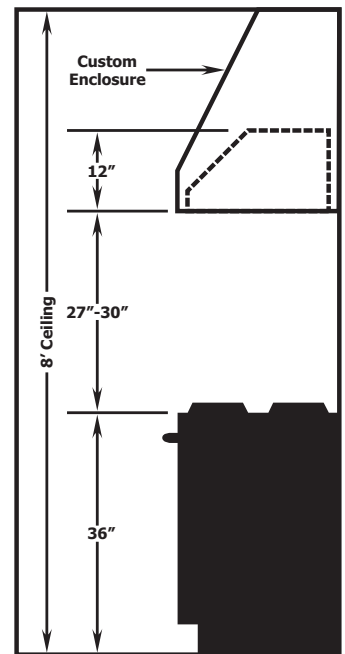

*Exceeding recommended mounting height may compromise performance.

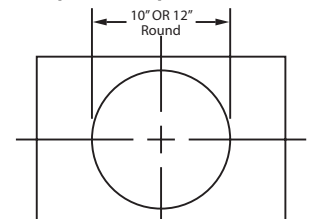

Transitions center outlet over top of hood

Electrical/Mechanical Specifications For Blower Units

Model	Volts	Amps*	RPM	CFM SP@0.0"	Equivalent CFM#	CFM SP@0.1"	CFM SP@0.2"	CFM SP@0.3"	Minimum Round Duct Size	Square Inches
B100 Single	115	1.7	1550	300	450	286	270	240	6" (or equivalent)	28
B200 Dual	115	3.4	1550	600	900	572	540	480	8" (or equivalent)	50

* Note: Add 0.5 amp for each halogen light. The 46 3/8" model is available with two fluorescent lights (1 for each single or dual blower). Both models are available with halogen lights (2 lights: 40 3/8", 3 lights: 46 3/8").

Because the Magic Lung® uses centrifugal filtration rather than conventional baffle or mesh filters, the Magic Lung® blower can handle cooking equipment with higher cubic feet per minute (CFM) requirements and can deliver equivalent CFM much more efficiently than other filtration systems. When comparing the Magic Lung® with other blower units made by other manufacturers, use the "Equivalent CFM".